

East Texas State Fair
September 22—October 2, 2011

2011
Creative Arts
Catalog



2112 West Front Street
Tyler, Texas 75702
(903) 597-2501 Fax: (903) 597-0692

www.etstatefair.com

The Park of East Texas Board of Directors

Officers and Executive Committee

Harold C. Beard, Chairman,
Randall L. Roberts, Vice Chairman
Felicity Reedy, Secretary
Lonny R. Uzzell, Treasurer
R.L. "Dick" Summers, Past Chairman
John Sykes, President/CEO

C.C. Baker	Terry Brannon	Herbert Buie
Ted Conover	Tom Deibel	Roy Lilly

Directors

Jesse Acosta	JoAnn Hampton	Danny Peggram
Rowe Anderson	Riley Harris	Shari Rickman
Henry Bell	Charles Hill	Chris Simons
Nancy Bracken	Gary Holbrooks	David Thedford
Gillian Brasfield	B. J. Hornbostel	Donnie Thedford
Martie Bigbie	Jeannie Lafferty	Michael Tolbert
Joe Cavender	Harry Leatherwood	Jeff Warr
Bobby Curtis	Sam Mezeyek	Mark Wells
Jim Giametta	Jay Misenheimer	
Kevin Halbert	Nathan Mimms	

Honorary Lifetime Directors

James I. Perkins
W. C. Edwards
Ben Fitzgerald
Sheriff J. B. Smith
James L. Wilkins

Honorary Lifetime Directors

D. M. Edwards Preston Smith

The Park of East Texas and East Texas State Fair Staff

John E. Sykes, President/CEO
Fred Lawrence, Bookkeeper
Ron Mott, Director of Maintenance
Deborah Newman, Director of Competitive Events
Heather Pickett, Director of Presentation & Development
Melanie Shadden, Coordinator of Commercial Exhibits
Cookie Young, Administrative Assistant

TABLE OF CONTENTS

Building Layout	1
Rules, Awards, and Premiums	3
Canned Food Guidelines	5
“FreshPreserving” Award	6
Division A - Youth Canned Foods	7
For ages 10 to 17 only	
Division B - Adult Canned Foods	9
For Adults, ages 18 and over	
Division C - Christmas & Holiday Corner	11
Christmas & Holiday Items - Sections for Youth and Adults	
Division D - Textile Department	13
Sections for Youth by age and Adults by experience level	
Division E - Special Populations	14
Special Needs Youth & Adults; Nursing Home Residents	
Division F - Youth Crafts	15
Sections for ages 17 and younger, including a few group classes	
Division G - Children’s Art	16
Sections for ages 9 and younger	
Division H - Quilts	18
Sections for Youth and Adults, including a few group classes	
Division I - Decorative Accessories	19
Sections for Youth by age and Adults by experience level	
Division J - Youth Collections & Hobbies	20
Sections for Youth, ages 17 and younger	
Division K - Adult Hand Painted China	21
Sections for Youth by age and Adults by experience level	
Division L - Adult Hobbies (Collections)	22
Division M - Adult Crafts	23
Includes classes for ceramics and pottery	
Division N - Antiques	25
Adult entries only	
Division O - Cake Decorating	26
Sections for Youth by age and Adults by experience level	
Division P - Adult Art	27
Division Q - Crochet, Weaving & Tatting	28
Sections for Youth by age and Adults by experience level	
Division R - Dolls	29
Sections for Youth by age and Adults by experience level	
Division S - Knitting	30
Sections for Youth by age and Adults by experience level	
Division U - Infants & Toddlers	31
Adult entries only based on level of experience	
Division V - Youth Art	32
Sections for Youth, ages 10 to 17	
Division W - Tole & Decorative Painting	33
Entries based on level of experience	
Division X - Clothing	34
Sections for Youth by age and Adults by experience level	

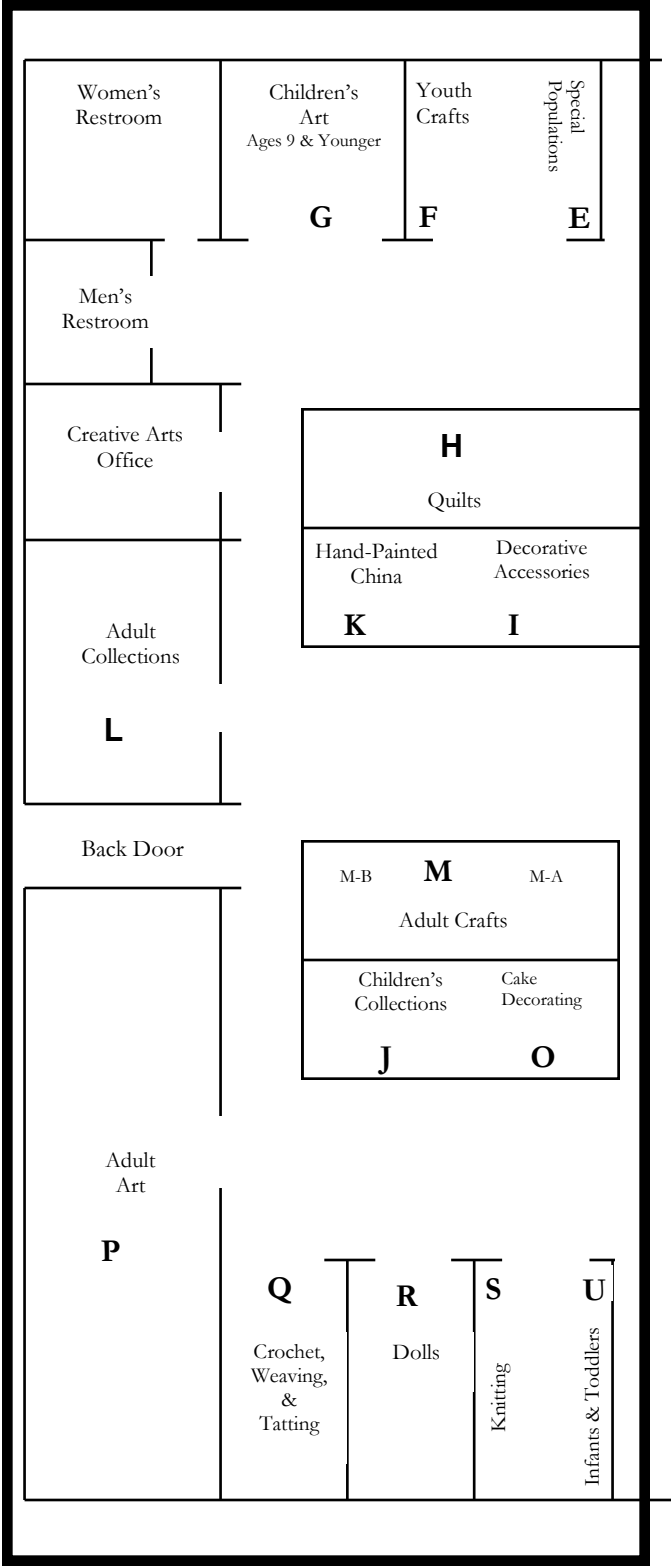

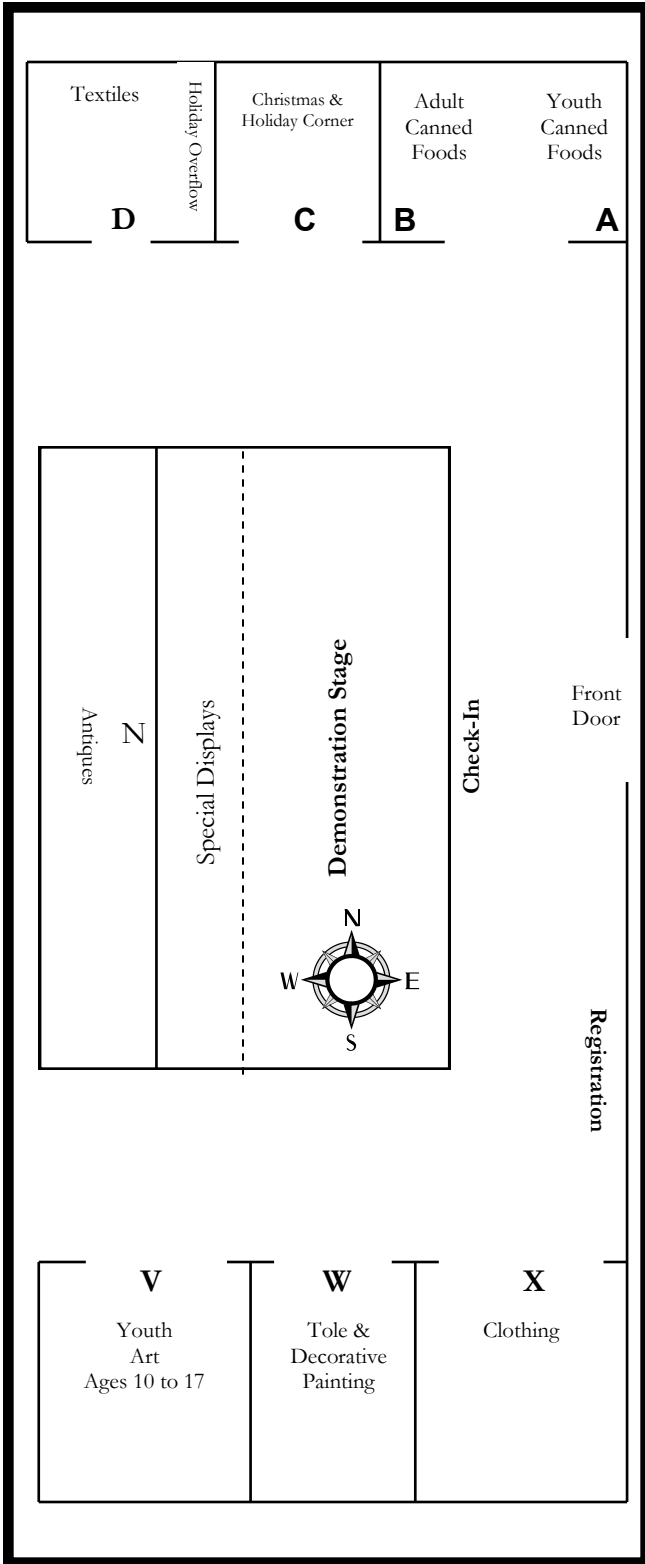

Textiles

Holiday Overflow

Christmas & Holiday Corner

Adult Canned Foods

Youth Canned Foods

D

C

B

A

Antiques

N

Special Displays

Demonstration Stage

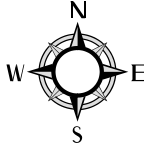

Check-In

Front Door

Registration

V

Youth Art
Ages 10 to 17

W

Toile & Decorative
Painting

X

Clothing

2011 CREATIVE ARTS RULES

EXHIBITS RECEIVED:

Thursday, September 8, 2:00-6:30 p.m.
Saturday, September 10, 9:00 a.m.-12:00 p.m.

JUDGING:

Week of September 18 - Results may be viewed after Fair opens.

EXHIBITS RELEASED:

Sunday, October 2 - 2:00 p.m. to 4:00 p.m.
Late Pick-up of Items: Monday, October 3 through Thursday,
October 6 from 9:30 a.m. to 4:30 p.m. in Building A

PREMIUMS PAIDS (See Page 5 for Premium Awards):

During the Fair - September 26-October 1
10:00 am to 1:00 pm in Fair Office only

No Premiums Paid on Sunday, October 2

After the Fair - Monday, October 3 through Thursday,
October 6 from 9:30 a.m. to 4:30 p.m. in Fair Office

All entries in the Department will be subject to the General Rules and Regulations of the East Texas State Fair.

1. Every care will be taken of articles exhibited, but ETSF will not be responsible for properties entered.
2. **No items** will be accepted for display or competition that are distasteful, suggestive, offensive or controversial.
3. All pieces for exhibit must be brought to the Creative Arts Building (Building A) on the designated days. Entries will NOT be accepted by mail or other delivery or early.
4. All articles except antiques and hobbies entered in competition in this department must have been made within the last two years, and **can only be exhibited in the name of the individual making the item.**
5. Youth Safety: The expectation is that crafts which would require the use of tools or equipment typically unsafe for use by youth will be used under the supervision of an adult, but the primary work in creating the item will be that of the youth involved.
6. See Page 6 for Canned Foods Guidelines.
7. Any articles that have previously been exhibited for competition during any East Texas State Fair will not be accepted. Items that have taken premiums in a previous East Texas State Fair may be displayed if space permits.
8. Each exhibitor is permitted only one entry in each class.
9. Exhibitors must can their own products and do their own sewing and home improvement work for exhibit.
10. Exhibitors entering articles in Youth Divisions or Sections must be 17 years of age or younger.
11. Teachers and professionals may give a business card to Division Coordinator to place by exhibit after judging.
12. Judges must not award a premium to any unworthy exhibit, regardless of the number of entries in a class. When fewer than 3 entries are entered in a class, ribbons will be awarded at the discretion of the judges.

13. A fair and impartial arrangement of pictures and articles for advantageous showing will be made as conditions permit. Due to limited space, all pictures must be **framed and wired** for hanging. Wood frames are preferred. No **Saw tooth hangers**.
14. A specimen must be an article entirely finished.
15. All home improvement articles, such as quilts, rugs, etc., and all clothing must be clean. No article will be accepted that is soiled, shows wear or is unfit for exhibition. All articles must have been made in the last two years by the exhibitor.
16. All exhibitors in this department are prohibited from removing their entries from the exhibit place. All exhibits must remain in place until 2:00 p.m. on Sunday, October 2, and must be checked out by 4:00 p.m.
17. Entries can be obtained only by presentation of claim check to Creative Arts Coordinators on Sunday, October 2, between 2:00 and 4:00 p.m. or in the ETSF Office during the week following the Fair according to the schedule outlined on page 3.

All exhibit items not claimed by October 6, 2011, will be disposed of at the discretion of the East Texas State Fair.

PREMIUMS

Youth and Special Populations Premiums

For all **youth** classes, the following premiums will be paid:

1st Place - \$3.00 2nd Place - \$2.00 3rd Place - \$1.00
 Section TriColor - \$5.00 to replace 1st Place

Adult Premiums

(Does NOT include Special Populations)

Section TriColors - \$20.00 Premier Exhibitors - \$25.00

NO premiums will be paid for 1st Place, 2nd Place, or 3rd Place awards in individual adult classes.

4 Premier Exhibitors are selected based on accumulated points in certain adult divisions and/or classes as listed below. Teachers and professionals are NOT eligible for Premier Exhibitor honors.

Culinary Arts: Divisions B and O

Crafts & Hobbies: Divisions L, M, and N; some classes in Divisions C and I

Fine Arts: Divisions K, P, R, and W

Needle Arts: Divisions D, H, Q, S, U, W, and some classes in Divisions C and I

For **Premier Exhibitor** points will be accumulated as follows:

1st Place = 4 points
 2nd Place = 3 points
 3rd Place = 2 points
 Honorable Mention = 1 point.



Creative Arts Demonstrations

Individuals are invited to demonstrate craft skills and techniques during one or more of the scheduled demonstration times during the Fair. Contact the Fair office to present a demonstration.

Demonstration schedule will be posted in Building A during the Fair.



Guidelines for Canned Food

1. Canned items will be in standard glass containers, such as Mason, Ball, and Kerr jars.
2. Canned items accepted must have been canned October 2009 or later **by the exhibitor**.
3. There will be only one (1) jar per exhibitor in each class.
4. Vegetables, Fruits, Juices, Meats, and Sauces may be canned in quarts and pints.
5. Jams, Jellies, Pickles, Relishes, and Butters may be canned in quarts, pints, 1/2 pints, or jelly jars.
6. There must be no rusted lids.
7. All "screw rings" (rims) must be removed before entering.
8. All vegetables and fruits entered must be **below** the liquid and **1/2 inch from the top of the jar**.
9. All jars must be clean on the outside.
10. Jars with popped lids or open lids will not be accepted. All lids must be sealed closed.
11. No warm jars will be accepted.
12. Each jar entered must contain a label with the following information:

Name of the Food
Method of Food Preservation
Date Preserved

Examples:

° Peaches, hot pack, boiling water canner, 20 minutes. July 13, 2003.

° Spaghetti sauce, hot pack, pressure canner, 11 pounds pressure, 45 minutes. July 14, 2003.

13. No personal names will be allowed on the jars.
14. See Special Food Preservation Awards provided to participants in Division A & B - Youth and Adult Canned Foods, provided compliments of Alltrista Consumer Products Company.



**BALL® Fresh Preserving™ Award
Adult Level**

**Presented by:
BALL® & KERR® FreshPreserving™ PRODUCTS**

Jarden Home Brands makers of BALL® and Kerr® FreshPreserving™ Products is proud to recognize today's fresh preserving (canning) enthusiasts, so First and Second Place Awards will be given to those individuals judged as the best in designated recipe categories.

A panel of judges will select the two best entries submitted by an adult for Fruit, Vegetable, Pickle, and Soft Spread categories. Entries must be preserved in Ball® or Ball® Collection Elite® Jars sealed with Ball® Lids and Bands or Ball® Lids and Bands or Ball® Collection Elite® Lids and Bands. In addition, soft spread entries will be limited to recipes prepared using Ball® Pectin: Original, No Sugar Needed or Liquid.

Entries designated First Place from each category will receive the following:

- Two (2) Five Dollar (\$5.00) Coupons for Ball® or Kerr® FreshPreserving™ Products and one (1) Three – Dollar (\$3.00) Coupon for Ball® Simple Creations® Products.

Entries designated Second Place from each category will receive the following:

- Two (2) Five-Dollar (\$5.00) Coupons for Ball® or Kerr® FreshPreserving™ Products

Youth Level

In Recognition of youth who excel in the art of fresh preserving (canning), Jarden Home Brands makers of Ball® and Kerr® FreshPreserving™ Products will present First Place Awards in designated recipe categories.

A panel of judges will select the best entry submitted by an youth in each category for Fruit, Vegetable, Pickle, and Soft Spread categories. Entries must be preserved in Ball® or Ball® Collection Elite® Jars sealed with Ball® Lids and Bands or Ball® Lids and Bands or Ball® Collection Elite® Lids and Bands. In addition, soft spread entries will be limited to recipes prepared using Ball® Pectin: Original, No Sugar Needed or Liquid. The best entry from each category will receive the following:

- One (1) Five-Dollar (\$5.00) Coupons for Ball® or Kerr® FreshPreserving™ Products and one (1) Coupon for Ball Pectin Products.

FreshPreserving awards are mailed to the recipients several weeks after the Fair.

**DIVISION A
YOUTH CANNED FOODS**

Mrs. Georgia Brown, Chairman, Troup
Mrs. Lillie Broughton, Troup
Mrs. Johnnie Johnson, Troup
Mrs. Eddie Ray, Troup
Mrs. Ella Brown, Whitehouse

Rules: Refer to Guidelines for Canned Foods on Page 5.

(10 to 17 Years)

VEGETABLES

- | | |
|-----------------------------|-----------------------------|
| 1. Beets | 9. Peas, Purple Hull |
| 2. Carrots, whole or sliced | 10. Peas, any shelled/snaps |
| 3. Corn, Cream | 11. Squash |
| 4. Corn, Whole kernel | 12. Tomatoes |
| 5. Green Beans | 13. Wax (Yellow) Beans |
| 6. Greens, any kind | 14. Miscellaneous Vegetable |
| 7. Peas, Black-eyed | |
| 8. Peas, Cream | |

ASSORTED

- | | |
|------------------------|--------------------|
| 15. Vegetable Mixtures | 16. Vegetable Soup |
|------------------------|--------------------|

FRUIT

- | | |
|-------------|-------------------------|
| 17. Apples | 20. Pears |
| 18. Berries | 21. Miscellaneous Fruit |
| 19. Peaches | |

PICKLES

- | | |
|----------------------|---------------------------------|
| 22. Beets | 27. Miscellaneous Pickled Fruit |
| 23. Cucumbers, Dill | 28. Peppers |
| 24. Cucumbers, Mix | 29. Miscellaneous Pickles |
| 25. Cucumbers, Sweet | |
| 26. Okra | |

RELISHES

- | | |
|----------------------|----------------------------|
| 30. Chow Chow | 33. Pear Relish |
| 31. Vegetable Relish | 34. Miscellaneous Relishes |
| 32. Pepper Relish | |

MEATS

35. Miscellaneous Meats

Division A, continued

JUICES

- | | |
|-----------|-------------------------|
| 36. Apple | 39. Tomato |
| 37. Grape | 40. Miscellaneous Juice |
| 38. Plum | |

SAUCES

- | | |
|------------|--------------------------|
| 41. Apple | 43. Tomato |
| 42. Pepper | 44. Miscellaneous Sauces |

JELLIES

- | | |
|-----------|-------------------------|
| 45. Apple | 48. Pepper |
| 46. Grape | 49. Plum |
| 47. Peach | 50. Miscellaneous Jelly |

JAMS

- | | |
|-----------|------------------------|
| 51. Berry | 53. Strawberry |
| 52. Peach | 54. Miscellaneous Jams |

PRESERVES

- | | |
|-----------|-----------------------------|
| 55. Berry | 58. Strawberry |
| 56. Peach | 59. Miscellaneous Preserves |
| 57. Pear | |

MISCELLANEOUS

60. Any not mentioned above

**DIVISION B
ADULT CANNED FOODS**

Mrs. Cyndi Bazil, Tyler

Rules: Refer to Guidelines for Canned Foods on Page 5.

VEGETABLES

- | | |
|-----------------------------|-------------------------------------|
| 1. Beets, whole | 16. Peas, Crowder |
| 2. Beets, sliced | 17. Peas, Purple Hull |
| 3. Carrots, whole | 18. Pinto Beans, shelled |
| 4. Carrots, diced or sliced | 19. Pinto Beans, shelled with snaps |
| 5. Chili Peppers | 20. Sweet Potatoes |
| 6. Corn, Cream | 21. Tomatoes, Purced |
| 7. Corn, whole kernel | 22. Tomatoes, Stewed |
| 8. Green Beans, snapped | 23. Wax (Yellow) Beans, snapped |
| 9. Green Beans, whole | 24. Wax (Yellow) Beans, whole |
| 10. Greens, any kind | 25. Yellow Squash |
| 11. Kraut | 26. Zucchini Squash |
| 12. New Potatoes | 27. Miscellaneous Vegetable |
| 13. Okra | |
| 14. Peas, Black-eyed | |
| 15. Peas, Cream | |

ASSORTED

- | | |
|---------------------------------------|--------------------|
| 28. Mixed Vegetables, other than soup | 29. Vegetable Soup |
|---------------------------------------|--------------------|

FRUITS

- | | |
|------------------|-------------------------|
| 30. Apples | 34. Pears |
| 31. Blackberries | 35. Plums |
| 32. Figs | 36. Miscellaneous Fruit |
| 33. Peaches | |

PICKLES

- | | |
|-------------------------------|---------------------------|
| 37. Beets | 43. Green Tomato |
| 38. Cucumber Sticks | 44. Okra |
| 39. Cucumbers, Bread & Butter | 45. Peppers |
| 40. Cucumbers, Dill | 46. Squash Pickles |
| 41. Cucumbers, Mix | 47. Miscellaneous Pickles |
| 42. Cucumbers, Sweet | |

RELISHES

- | | |
|-------------------|----------------------------|
| 48. Chow Chow | 51. Tomato Relish |
| 49. Pepper Relish | 52. Vegetable Relish |
| 50. Squash Relish | 53. Miscellaneous Relishes |

MEATS

54. Miscellaneous Canned Meat

Division B, continued

SAUCES

- | | |
|-------------------|-------------------------|
| 55. Apple Sauce | 58. Tomato Sauce |
| 56. Picante Sauce | 59. Miscellaneous Salsa |
| 57. Tomato Catsup | 60. Miscellaneous Sauce |

JUICES

- | | |
|------------------|-------------------------|
| 61. Apple Juice | 64. Plum Juice |
| 62. Berry Juice | 65. Tomato Juice |
| 63. Cherry Juice | 66. Miscellaneous Juice |

JELLIES

- | | |
|----------------|-------------------------|
| 67. Apple | 71. Peach |
| 68. Blackberry | 72. Pepper |
| 69. Grape | 73. Plum |
| 70. Muscadine | 74. Miscellaneous Jelly |

JAMS

- | | |
|----------------|------------------------|
| 75. Blackberry | 78. Plum |
| 76. Muscadine | 79. Strawberry |
| 77. Peach | 80. Miscellaneous Jams |

PRESERVES

- | | |
|----------------------|-----------------------------|
| 81. Blackberry | 86. Strawberry |
| 82. Citrus Marmalade | 87. Watermelon Rind |
| 83. Fig | 88. Miscellaneous Preserves |
| 84. Peach | |
| 85. Pear | |

BUTTERS

- | | |
|------------------|--------------------------|
| 89. Apple Butter | 92. Pear Butter |
| 90. Plum Butter | 93. Miscellaneous Butter |
| 91. Peach Butter | |

MISCELLANEOUS

- | | |
|--|-------------------------|
| 94. Miscellaneous Mincemeats | 96. Other Miscellaneous |
| 95. Miscellaneous Fruit Honey or Syrup | |

Division B Points apply to Culinary Arts Premier Exhibitor honors.

DIVISION C
CHRISTMAS and HOLIDAY CORNER

Mrs. Dyane Garner, Tyler
Mr. Doug Garner, Tyler
Ms. Kathy Miller, Flint

Section A - Adults, ages 18 and Older These classes ONLY

ORNAMENTS

1. Ornament - Original, hand-crafted
2. Ornament - Hand-painted
3. Ornament - Other
4. Ornament Collection
5. Tree Top Item

STOCKINGS

6. Stocking from felt
7. Stocking - Cross Stitch
8. Stocking from other fabric
9. Stocking from Kit or Purchased and Decorated (judged on workmanship)

TREE SKIRTS

10. Tree Skirt, original design, not to exceed 36"
11. Tree Skirt, made from kit (judged on workmanship)

WREATHS

12. Wreath, handmade from natural materials
13. Wreath, fabric or decorated wreath form
14. Wreath from Kit (judged on workmanship)

INDOOR CHRISTMAS DÉCOR

15. Ceiling, Archway, or Wall Hangings, any material
16. Door or Window Decoration, other than wreath
17. Handmade figurines, no higher than 17"
18. Handmade Nativity Scene, no larger than 18"x12" and not taller than 17"
19. Kitchen Decoration
20. Mantle Decorations
21. Pillow, handmade, no larger than 12"x12"
22. Quilt, hand-quilted
23. Quilt, machine-quilted
24. Table Decoration, any

25. Any other indoor décor

CHRISTMAS SYMBOLS

26. Angels, stuffed fabric
27. Angels, other material
28. Santas, stuffed fabric
29. Santas, other material

DECORATIVE COLLECTIONS

30. Miniature tree, decorated with them, 3' or smaller
31. Decorative Collection, 10 pieces or less
32. Miniature Village, 15 pieces or less, hand painted

OUTDOOR DECOR

33. Hand-crafted from metal
34. Hand-crafted from wood
35. Hand-crafted from other material

HOLIDAY APPAREL

36. Apron
37. Decorated shirt or T-shirt
38. Original handmade item
39. Jewelry

HOLIDAY DÉCOR FROM KITS

40. Outdoor Item
41. Indoor Decoration
42. Miscellaneous Decoration

OTHER HOLIDAY ITEMS

43. Chanukah Decoration
44. Easter Decoration
45. Halloween Decoration
46. Thanksgiving Decoration
47. Patriotic Decoration
48. Floral Arrangement
49. Decorated Clothing, other than Christmas

HOLIDAY NEEDLEWORK

50. Crochet Item
51. Knitted Item
52. Cross Stitch Item
53. Hand Embroidery

DIVISION C, continued

Adult Premier Exhibitor Points will be applied as follows:

Crafts & Hobbies

Classes 1-5, 12-20, 24-25, 27, 29-35, 39-49

Needle Arts

Classes 6-11, 21-23, 26, 28, 36-38, 50-54

Section B - Youth, ages 17 and Younger

Youth are limited to these classes.

CHRISTMAS DECORATIONS

1. Tree Skirt, any handmade or decorated
2. Ornament or Tree Decoration - Original, hand-crafted
3. Ornament or Tree Decoration - Hand-painted purchased item
4. Other Ornament or Tree Decoration
5. Stocking, handmade or decorated
6. Miniature Tree, decorated with theme, 3' or smaller

HOLIDAY NEEDLEWORK

13. Apron
14. Decorated shirt or T-shirt
15. Original handmade item
16. Jewelry
17. Cross Stitch Item
18. Embroidery
19. Miscellaneous Holiday Needlework

HOLIDAY DÉCOR

7. Wreath, any holiday, handmade or decorated
8. Indoor Decoration, any holiday
9. Outdoor Decoration, any holiday
10. Pillow, handmade, no larger than 12"x12"
11. Quilt, any holiday
12. Decorative Holiday Collection, including Holiday Villages, must fit in an 18"x12" space

**DIVISION D
TEXTILES**

Ms. Karen Pensinger, Bullard
Ms. Pat Wilkins, Tyler

Section A - Adults, ages 18 and Older

Adult points apply to Needle Arts Premier Exhibitor honors.

HAND EMBROIDERY

1. Picture, original design
2. Any Apparel Item
3. Any Decorative Item
4. Any Item from a Kit

MACHINE EMBROIDERY

5. Picture, original design
6. Any Apparel Item
7. Any Decorative Item
8. Any Item from a Kit

CROSS STITCH

9. Picture, original design
10. Picture, from Kit
11. On Linen
12. Any Apparel Item
13. Any Decorative Item

COUNTED 16 COUNT & UP

14. Picture, original design
15. Picture, from Kit
16. Sampler
17. On Linen
18. Any Apparel Item
19. Any Decorative Item

COUNTED 14 & UNDER

20. Picture, original design
21. Picture, from Kit
22. Sampler
23. On Linen
24. Any Apparel Item
25. Any Decorative Item

APPLIQUÉ

26. Any Apparel Item
27. Any Decorative Item

CUT WORK

28. Any Apparel Item
29. Any Decorative Item

CREWEL

30. Any Apparel Item
31. Any Decorative Item

BEAD and SEQUIN

32. Original Design
33. Any Apparel Item
34. Any Decorative Item

NEEDLEPOINT

35. Original Design
36. Tapestry or Rug
37. Other Decorative Item
38. Accessory (purse, bag, etc.)

PETITPOINT

39. Picture
40. Tapestry or Rug
41. Other Decorative Item
42. Accessory (purse, bag, etc.)

OTHER NEEDLEWORK

43. Bargello
44. Batik
45. Brazilian Embroidery
46. French Sewing
47. Japanese Embroidery
48. Plastic Canvas
49. Pointillism
50. Pretty Punch
51. Swedish Embroidery
52. Candle Wicking
53. Miscellaneous

TEXTILE WEAVING

54. Hot Pad or Pot Holder
55. Loom Piece
56. Loom Piece as garment
57. Rug, woven
58. Miscellaneous Weaving

Section B - Youth, ages 13 and Younger

Section C - Youth, ages 14 to 17

Youth are limited to the following classes.

1. Embroidery, any item
2. Cross Stitch, any item
3. Appliqué, any item
4. Crewel, any item
5. Needlepoint, any item
6. Batik, any item
7. Textile Weaving, any item
8. Other Textile Needlework

**DIVISION E
SPECIAL POPULATIONS**

Ms. Karen Charles, Tyler

Section A - Adults, ages 18 and Older

Special Needs Adults, Nursing Home or Institutional Residents
Adults are limited to the following classes.

- | HOLIDAY
DECORATIONS | ART |
|--------------------------------|--------------------------|
| 1. Christmas Ornament | 16. Oil Painting |
| 2. Christmas Decoration | 17. Acrylic Painting |
| 3. Other Holiday Decoration | 18. Tempera Painting |
| | 19. Pencil Drawing |
| | 20. Pen Drawing |
| | 21. Collage |
| | 22. Crayon |
| | 23. Mixed Medium |
| | |
| TEXTILES | SPECIALTY HOBBIES |
| 4. Embroidery | 24. Hand-quilted Item |
| 5. Cross Stitch | 25. Ceramic Item |
| 6. Appliqué | 26. Clay Sculpture |
| 7. Bead or Sequin Work | 27. Collection |
| | 28. Crocheted Item |
| CRAFTS | 29. Knitted Item |
| 8. Jewelry | 30. Pottery |
| 9. Latch Hook Project | 31. Jewelry |
| 10. Metal Craft | 32. Miscellaneous Craft |
| 11. Paper Craft | |
| 12. Plaster Item | |
| 13. String Art | |
| 14. Styrofoam Craft | |
| 15. Weaving | |

Section B - Special Needs Youth, ages 13 and Younger

Section C - Special Needs Youth, ages 14 to 17

Youth are limited to the following classes.

- | HOLIDAY
DECORATIONS | ART |
|-------------------------------------|--------------------------|
| 1. Christmas Ornament | 14. Oil Painting |
| 2. Holiday Decoration | 15. Acrylic Painting |
| | 16. Tempera Painting |
| | 17. Pencil Drawing |
| | 18. Pen Drawing |
| | 19. Collage |
| | 20. Crayon |
| | 21. Mixed Medium |
| TEXTILES | SPECIALTY HOBBIES |
| 3. Cross Stitch | 22. Ceramic Item |
| 4. Other Textile | 23. Collection |
| | 24. Crocheted Item |
| CRAFTS | 25. Knitted Item |
| 5. Assembled Transportation
Item | 26. Pottery |
| 6. Clay Sculpture | 27. Miscellaneous Item |
| 7. Jewelry | 28. Group Crafts |
| 8. Metal Craft | |
| 9. Paper Craft | |
| 10. Plaster Item | |
| 11. String Art | |
| 12. Styrofoam Craft | |
| 13. Weaving | |

**DIVISION F
YOUTH CRAFTS**

Mrs. Anna Seiden, Chairman, Tyler
Mrs. Mindy Meisenheimer, Tyler
Mrs. Ann Edwards, Tyler
Ms. Rilla McMillan, Tyler

Only 5 classes per exhibitor will be accepted. Any items made with food MUST be shellacked or painted. School Group entries will not be eligible for the Tri-Color Ribbon. See safety rules on page 3, #5.

Section A - Ages 5 and Younger

Ages 5 and younger are limited to the following twenty-four classes.

- | | |
|-------------------------------------|--|
| 1. Assembled Transportation Item | 13. Lacing creation (doll, etc.) |
| 2. Beadwork Design | 14. Magnet Decoration |
| 3. Book Marker | 15. Mobile |
| 4. Ceramic Item, hand-crafted | 16. Paper Craft |
| 5. Craft Picture | 17. Paper Macheé |
| 6. Craft Stick Craft | 18. Pen & Pencil Holders |
| 7. Diorama (Scene, 3-D Model) | 19. Play Dough or Modeling Clay Design |
| 8. Fun Foam Craft | 20. Recycled Creation |
| 9. Glitter Craft | 21. Sand Art |
| 10. Hand-Painted Clothing Item | 22. Shell Creation |
| 11. Jewelry | 23. Styrofoam Craft |
| 12. Lego or Building Block Creation | 24. Miscellaneous Preschool Craft |

Section B- Ages 6 to 9

Section C - Ages 10 to 13

Section D - Ages 14 to 17

GENERAL CRAFTS

- | | |
|--|---|
| 25. Assembled Transportation Item | 45. Scrapbook |
| 26. Beadwork Design | 46. String Art |
| 27. Book Marker | 47. Miscellaneous General Craft |
| 28. Clay or Play-dough Creation, not fired ceramic piece | SKILLED CRAFTS |
| 29. Craft Picture | 48. Wood Burning Item |
| 30. Diorama (Scene, 3-D Model) | 49. American Indian Craft other than Leather or Pottery |
| 31. Fun Foam Craft | 50. Ceramic Item, glazed & fired |
| 32. Hand-Painted Clothing | 51. Doll Clothing, Handmade |
| 33. Hand-Painted Item, Other | 52. Doll, Handmade Limber |
| 34. Lego or Building Block Creation | 53. Doll, Handmade Stand-up |
| 35. Magnet Decoration | 54. Dollhouse, handcrafted |
| 36. Mobile | 55. Jewelry |
| 37. Models (animals, etc.) | 56. Leather Craft |
| 38. Nature Creative Item (shells, seeds, etc.) | 57. Metal Craft |
| 39. Paper Craft | 58. Pottery Item |
| 40. Paper Maché | 59. Sculpture, Clay |
| 41. Plaster Craft | 60. Sculpture, Other |
| 42. Quilling | 61. Stained Glass |
| 43. Recycled Creation | 62. Wood Item, Handcrafted |
| 44. Sand Art | GROUP CRAFTS |

Not eligible for TriColor Awards - Award & Premium are shared by group.

- | |
|-------------------------|
| 63. Group Diorama |
| 64. Group Miscellaneous |

**DIVISION G
CHILDREN'S ART**

Mrs. Betty Mallory, Tyler
Mrs. Becky Omdahl, Tyler

Only 3 entries (no larger than 16" x 20" including frame) per exhibitor will be accepted. All entries **MUST** be framed with screws and wires for hanging. **Please leave 6 inch slack in wire on back of entry** for easier hanging. Remove glass from frame. **Art will not be accepted on paper, poster board, or cardboard UNLESS it is framed and wired for hanging.**

Section A – Ages 5 and Younger

Section B - Ages 6 to 9

OIL PAINTING

- | | |
|---------------------------|-----------------------|
| 1. Landscape/Seascape | 5. Animals & Wildlife |
| 2. Structure/Architecture | 6. Still Life |
| 3. Illustration | 7. Floral |
| 4. Portraits | 8. Abstract |

WATER COLOR PAINTING

- | | |
|----------------------------|------------------------|
| 9. Landscape/Seascape | 13. Animals & Wildlife |
| 10. Structure/Architecture | 14. Still Life |
| 11. Illustration | 15. Floral |
| 12. Portraits | 16. Abstract |

ACRYLIC

- | | |
|----------------------------|------------------------|
| 17. Landscape/Seascape | 21. Animals & Wildlife |
| 18. Structure/Architecture | 22. Still Life |
| 19. Illustration | 23. Floral |
| 20. Portraits | 24. Abstract |

PASTEL

- | | |
|----------------------------|------------------------|
| 25. Landscape/Seascape | 29. Animals & Wildlife |
| 26. Structure/Architecture | 30. Still Life |
| 27. Illustration | 31. Floral |
| 28. Portraits | 32. Abstract |

INK

- | | |
|----------------------------|------------------------|
| 33. Landscape/Seascape | 37. Animals & Wildlife |
| 34. Structure/Architecture | 38. Still Life |
| 35. Illustration | 39. Floral |
| 36. Portraits | 40. Abstract |

DIVISION G, continued

PENCIL, CHARCOAL, COLORED PENCIL

- | | |
|----------------------------|------------------------|
| 41. Landscape/Seascape | 45. Animals & Wildlife |
| 42. Structure/Architecture | 46. Still Life |
| 43. Illustration | 47. Floral |
| 44. Portraits | 48. Abstract |

CRAYON

- | | |
|----------------------------|------------------------|
| 49. Landscape/Seascape | 53. Animals & Wildlife |
| 50. Structure/Architecture | 54. Still Life |
| 51. Illustration | 55. Floral |
| 52. Portraits | 56. Abstract |

MIXED MEDIA

- | | |
|----------------------------|------------------------|
| 57. Landscape/Seascape | 61. Animals & Wildlife |
| 58. Structure/Architecture | 62. Still Life |
| 59. Illustration | 63. Floral |
| 60. Portraits | 64. Abstract |

TEMPERA

- | | |
|----------------------------|------------------------|
| 65. Landscape/Seascape | 69. Animals & Wildlife |
| 66. Structure/Architecture | 70. Still Life |
| 67. Illustration | 71. Floral |
| 68. Portraits | 72. Abstract |

SPECIALTY

- | | |
|------------------------|--|
| 73. Graphic/Technology | 77. Calligraphy |
| 74. Scratch Art | 78. Non-original Design
(Paint-by-Number, Coloring
Page, etc.) |
| 75. Rolled Art | |
| 76. Collage | |

DIVISION H QUILTS

Mrs. Alice Fennell, Chairman, Lindale
Mrs. Debbie Penett, Tyler
Mrs. Shirley Quaas, Lindale
Ms. Carol Slaton, Tyler

Due to limited space, only 3 quilts per exhibitor will be accepted.
Quilts should not be soiled or smell of smoke.

Section A - Adult Beginners (3 years or less)

Section B - Adult Intermediate or Advanced (4 or more years.)

Baby articles must be submitted to Division U - Infants & Toddlers

Adults are limited to the following classes.

APPLIQUÉ QUILTS

- | | |
|-----------------------------------|---------------------------|
| 1. All Handmade | 15. Embroidery |
| 2. All Machine Made | 16. Cross Stitch |
| 3. Combined Hand and Machine Made | 17. Stencil |
| | 18. Printed Design |
| | 19. Miscellaneous Novelty |

PATCHWORK QUILTS

- All Handmade
- All Machine Made
- Combined Hand and Machine Made

PATCHWORK/APPLIQUÉ

- All Handmade
- All Machine Made
- Combined Hand and Machine Made

QUILTS FROM KITS

- All Handmade
- All Machine Made

NOVELTY QUILTS

- Yo Yo
- Cathedral Window
- Candlewicking

GROUP QUILTS

Not eligible for TriColor or Premier Exhibitor Awards

Award shared by participants

20. Appliqué - all handmade
21. Appliqué - all machine made
22. Patchwork - all handmade
23. Patchwork - all machine made
24. Patchwork/Appliqué - all handmade
25. Patchwork/Appliqué - all machine made

“Prettiest”, “Best Use of Color” and “Best Hand Quilting” honors will be selected from all quilts entered in the Adult Section.

YOUTH QUILTS

Section C - Youth, Ages 13 and Younger

Section D - Youth, Ages 14 to 17

Youth are limited to the following classes.

INDIVIDUAL WORK

- Appliqué Quilt
- Patchwork Quilt
- Quilts from Kits
- Printed Design Quilt
- Novelty Design Quilt

GROUP QUILTS

Not eligible for TriColor Awards; Award and Premium are shared by the group.

6. Appliqué Quilt
7. Patchwork Quilt
8. Quilt from Kit
9. Novelty or Other Quilt

**DIVISION I
DECORATIVE ACCESSORIES**

Mrs. Barbara Garrett, Tyler

Section A - Adults, Ages 18 and Older

No Holiday Items or Infant & Toddler Items

Quilted wall hangings will be judged overall as a wall hanging and not specifically on quilting skills and techniques.

Adults are limited to the following classes.

- | BED & BATH | OTHER DECORATIVE ITEMS |
|---|---|
| 1. Pillows, handmade | 19. Decorated Picture Frames |
| 2. Pillow Cover or Pillow Sham, removable | 20. Mirrors |
| 3. Pillow Cases | 21. Covered Boxes |
| 4. Bed Throw, other than crocheted or knitted | 22. Decorated Windows |
| 5. Coverlet, any style | 23. Novelty Kitchen Items |
| 6. Bedspreads, any style | 24. Basket, hand-decorated |
| 7. Towels | 25. Pin Cushion, handmade or Decorated |
| 8. Vanity Decorations | 26. Wall Decoration |
| 9. Matching Complete Bed Ensembles | 27. Wooden Holders & Accessories |
| 10. Bath Accessories (cups, holders, etc.) | 28. Decorative Wall Hanging, other than Holiday |
| | 29. Lap Throw, other than crocheted or knitted |
| | 30. Window Dressing |
| | 31. Chair Cushions |
| | 32. Table Runners |
| | 33. Table Cloths or Covers |
| | 34. Decorative Lampshade |
| | 35. Braided Item other than Rug |
| | 36. Latch hook, other than rug |
| | 37. Miscellaneous Decorative Item |
- FLORAL & WREATHS**
11. Floral Arrangement, Small
 12. Floral Arrangement, Large
 13. Handmade Wreath from all Natural Materials
 14. Decorated Wreath, any material
- RUGS & MATS**
15. Braided rug or Mat
 16. Latch hook, original or kit
 17. Painted
 18. Miscellaneous Rug or Mat
- Woven Rugs go to Division D - Textiles

Adult Premier Exhibitor Points will be applied as follows:

Crafts & Hobbies: Classes 8, 10-28, 34-35

Needle Arts: Classes 1-7, 9, 29-33

Section B - Youth, Ages 13 and Younger

Section C - Youth, Ages 14 to 17

YOUTH DECORATIVE

No Holiday Items

Youth are limited to the following classes.

- | | |
|---------------------------|---------------------------------|
| 1. Pillows, handmade | 7. Decorated Basket |
| 2. Pillow Cases | 8. Latch Hook Rug or Mat |
| 3. Floral Arrangement | 9. Decorated/Painted Rug or Mat |
| 4. Decorated Wreath | |
| 5. Decorated Wall Hanging | 10. Quilt, Blanket or |
| 6. Table Decoration | Throw—Not Quilted |

DIVISION J
CHILDREN'S COLLECTIONS AND HOBBIES

Mr. Hiram & Mrs. Oleta Watson, Arp
Ms. Rebecca Dale, Tyler

Section A - Youth, Ages 9 & Younger

Section B - Youth, Ages 10 to 17

A collection must consist of **3 or more items**. Due to limited space, **ALL** collections **MUST** fit in a 16" x 12" space with no item taller than 12". Each exhibitor may enter only 4 classes.

1. Accessory Items (Belt Buckles, Shoes, Jewelry, Handkerchiefs, Key Chains, etc.)
2. Animals, Wildlife, or Sea life Figurines or Models, not stuffed
3. Antique Toys
4. Awards (Ribbons, Medals, Pins, Patches)
5. Books (Story Books, Comic Books, etc.)
6. Bottles or Glassware
7. Bugs (Entomology)
8. Cards other than Sport Cards (Barbie, Post Cards, etc.)
9. Cars & Other Transportation Items
10. Character Toys (Action Figures, Promotional Characters, Disney, Pez Dispensers, etc.)
11. Clocks
12. Coin or Money Collection
13. Dolls, not stuffed (including clowns)
14. Figurines
15. Household Items (Magnets, Flowers, Cooking Utensils, Pencils, Paperweights, Pencil Sharpeners, etc.)
16. Nature Items (Seeds, Shells, etc.)
17. Occupational or Hobby Collection (Military Patches, Fishing Items, Rope Knots, etc.)
18. Puzzles
19. Rocks or Gem Stones
20. Specialty Toys (Marbles, Yo-Yos, etc.)
21. Sports Collections (Baseballs, Autographs, Sports Cards, Pennants, etc.)
22. Stamps
23. Stuffed or Bean Bag Toys (Beanie Babies, Care Bears, Bears, Dolls, Animals, etc.)
24. Miscellaneous Collection

**DIVISION K
HAND PAINTED CHINA**

Mrs. Helen Pyron, Tyler

Adult points apply to Fine Arts Premiere Exhibitor honors.

Section A - Adults, Beginner or Novice (3 years or less)

Section B - Adults, Intermediate (4 to 8 years)

Section C - Adults, Advanced (More than 8 years)

Section D - Teachers/Professionals

Adults are limited to the following classes.

Base or Special Technique	17. Roses
1. Enamelware	18. Seasonal or Holiday
2. Glass	19. Scenes
3. Raised Paste	20. Scrolls
4. Stoneware	21. Wildlife or Animals
5. Lace Draping	
Design Treatment	Specialty Pieces
6. Bisque	22. Coffee or Tea Sets
7. Gold	23. Dinner Set (3 or more -
8. Lustre	1 place set)
Designs	24. Figurines-single or pairs
9. Dresden	25. Jewelry
10. Floral, other than roses	26. Pairs or Series (2-4 pieces)
11. Fruits, Berries, or	27. Miniatures
Vegetables	28. Miscellaneous Sets
12. Marine Life	(Bisque)
13. Monochrome	29. Miscellaneous Sets -
14. Nuts or Pine Cones	Other
15. Pen Work	
16. Portraits	
1. CHINA (Object to be decorated)	
a. Quality.....	10
2. DESIGN.....	40
a. Suitability to shape china.....	(10)
b. Proportion with due respect to usage.....	(10)
c. Focal point of interest if naturalistic.....	(5)
d. Balance, rhythm of the whole.....	(5)
e. Originality.....	(10)
3. COLOR.....	15
a. Harmony.....	(5)
b. Contrast.....	(5)
c. Value.....	(5)
4. TECHNIQUE.....	25
a. Application of color (delicate or heavy).....	(10)
b. Perspective.....	(10)
c. Light and Shadows.....	(5)
5. FIRING.....	10

Section E - Youth, Ages 13 and Younger

Section F - Youth, Ages 14 to 17

Youth are limited to the following classes.

- | | |
|-----------------------------|----------|
| 1. Seasonal or Holiday Item | 3. China |
| 2. Figurines | 4. Sets |

**DIVISION L
ADULT COLLECTIONS**

Adults, Ages 18 and Older ONLY

Mrs. Pat Craig, Flint
Mrs. Jeri Simonton, Tyler

Due to limited space, only 3 classes per exhibitor.

A collection must consist of **3 or more items**.

Collection display **MUST** fit into an area that is 2 feet wide
and 16" long and no item taller than 12".

Exceptions to this rule would be specific collectible items in
classes 44, 47, 49, 50, 52, and 53.

Adult Points apply to

Crafts & Hobbies Premier Exhibitor Honors

General Collections

- | | |
|---|---------------------------------------|
| 1. Angels | 30. Pencil Sharpeners |
| 2. Animals | 31. Pitcher & Creamer |
| 3. Ash Trays | 32. Pitchers |
| 4. Banks | 33. Post Cards |
| 5. Bells | 34. Rock Collection |
| 6. Bird Houses, small | 35. Salt & Pepper Shaker
Sets |
| 7. Bookmarks | 36. Salt Cellars |
| 8. Bottles | 37. Shells |
| 9. Boxes, Miscellaneous | 38. Spoons |
| 10. Buckles | 39. Tea Pots |
| 11. Buttons | 40. Thimbles |
| 12. Caps | 41. Toothpick Holders |
| 13. Ceramics, other than Salt
& Pepper Shakers | 42. Toys |
| 14. Clocks and Watches | 43. Miscellaneous
Collection |
| 15. Clowns | |
| 16. Coffee Mugs | Collectibles |
| 17. Cup & Saucer Sets | 44. Celebrity Items or
Memorabilia |
| 18. Cut or Colored Glass,
other than Bottles | 45. Coin or Money
Collection |
| 19. Die Cast Vehicles | 46. Collectible Cards |
| 20. Handkerchiefs | 47. Depression Glass |
| 21. Jewelry | 48. Dolls, small |
| 22. Key Chains | 49. Historical Items |
| 23. Lighthouses | 50. Sports Memorabilia |
| 24. Magnets | 51. Stamps |
| 25. Matchbooks | 52. Vintage Items |
| 26. Music Boxes, small | 53. Miscellaneous
Collectibles |
| 27. Old Books | |
| 28. Paper Weights | |
| 29. Patriotic Items | |

**DIVISION M
ADULT CRAFTS**

Adults, Ages 18 and Older

No Christmas or Holiday Articles Accepted—See Division C

Section A - General Crafts

Ms. Rebecca Karaska, Tyler

Points apply as follows for Premiere Exhibitor

Crafts & Hobbies: Classes 8, 10-28, 35;

Needle Arts: Classes 1-7, 9, 29-34

- | | |
|---|---|
| 1. Bead Designs | 20. Paper Craft (Handmade cards, Quilling, Cutwork, etc.) |
| 2. Clay Art | 21. Paper Maché |
| 3. Collage | 22. Pine Cone Art |
| 4. Corsages & Mums | 23. Plaster Craft |
| 5. Covered Books | 24. Plastic Models |
| 6. Craft Pictures, any materials | 25. Purses, other than Fabric or Leather |
| 7. Decorated Gourds | 26. Recycled Items |
| 8. Decorated Rocks | 27. Restored Dolls, other than porcelain |
| 9. Decoupage | 28. Scrapbook Album |
| 10. Fabric Painting, any item | 29. Scrapbook Page |
| 11. Glass Art | 30. Shadow Box |
| 12. Handmade Candles | 31. Shell Art |
| 13. Handmade Soft Body Doll, over 12" | 32. Soap, homemade |
| 14. Handmade Soft Body Doll, under 12" | 33. Stuffed Decorations |
| 15. Handmade Stuffed Toys other than Dolls | 34. Wedding Accessories, Handmade |
| 16. American Indian & Southwestern Articles, other than Leather and Pottery | 35. Wedding, Decorated Purchased Items |
| 17. Macramé | 36. Yard Decoration, other than Holiday |
| 18. Match or Toothpick Art | 37. Miscellaneous General Craft |
| 19. Mop Head Dolls | |

DIVISION M, continued

Section B - Skilled Crafts

Ms. Esther Rightmyer, Bullard
Mrs. Linda Timmons, Lindale

Points apply as follows for Premiere Exhibitor
Crafts & Hobbies: Classes 1-18, 22-24, 27-29, 31
FineArts: Classes 19-21, 25-26, 30

Wood Crafts

1. Bird Houses & Feeders
2. Clocks
3. Doll Furniture
4. Doll Houses from Kits
5. Doll Houses, Handmade
6. Furniture, large item
7. Furniture, small item
8. Picture Frame
9. Planters
10. Woodburning, any item
11. Any other Wood Craft Item

Woodworking

12. Carving
13. Inlay, Lamination, Intarsia (any kind)
14. Scroll Work
15. Turning
16. Toys

Jewelry

17. Beaded Jewelry
18. Hair Decorations
19. Jewelry Sets, 2 pieces or less
20. Wire Jewelry, any item
21. Any other Jewelry Item

Leather Work

22. Any Large Leather Work Item
23. Belts, Coin Purses, or any Small Item
24. Purses

Miscellaneous Skilled Craft

25. Any Ceramic Piece
26. Any Pottery Item
27. Any Metal Work Item, other than Jewelry
28. Handmade Lamp, any materials
29. Any Handmade Basket Weaving Item
30. Stained Glass, any item
31. Miscellaneous Skilled Craft Item

**DIVISION N
ANTIQUES**

Adults, Ages 18 and Older

Mrs. Harriett Lane, Tyler

Points apply to Crafts & Hobbies Premiere Exhibitor

Items entered must be at least 50 years old.

Item must be owned by the exhibitor.

Each article should be accompanied by a card giving the age of the item and other historical information. Age of article will not be a deciding factor in determining placing of the article. Instead the beauty, condition and quality of the exhibit will be considered in placing each entry.

Articles must be small enough to display on cabinet shelves. Larger items will be accepted ONLY if an appropriate display space is available. Space for articles larger than 2 feet wide x 16 inches long and 12 inches tall are limited.

Each exhibitor is permitted only one entry per class. Duplicate items will be exhibited together, not in separate classes. Articles previously exhibited for competition during any East Texas State Fair will not be accepted.

- | | |
|----------------------------|--|
| 1. Art Glass | 26. Magazines |
| 2. Baby Clothes | 27. Maps |
| 3. Baskets | 28. Mechanical Banks |
| 4. Books | 29. Metal Article, any style
other than Tin |
| 5. Bottles | 30. Milk Glass |
| 6. Cameras | 31. Money |
| 7. Cards | 32. Mugs (shaving, etc.) |
| 8. Carnival Glass | 33. Newspapers |
| 9. China | 34. Pattern Glass |
| 10. Combs | 35. Pen & Pencil Sets |
| 11. Crocks | 36. Phonograph Records |
| 12. Cut Glass | 37. Pictures |
| 13. Depression Glass | 38. Pottery |
| 14. Dolls | 39. Pressed Glass |
| 15. Dresser Sets | 40. Purses |
| 16. Eyeglasses | 41. Quilt, any style |
| 17. Fabric Items, Vintage | 42. Sewing Articles |
| 18. Fans | 43. Smoking Items |
| 19. Figurines | 44. Souvenirs or Keepsakes |
| 20. Handkerchiefs | 45. Tin Items |
| 21. Handwork, any material | 46. Toys |
| 22. Jars | 47. Wall Pocket |
| 23. Jewelry | 48. Wood Articles |
| 24. Kitchen Ware | 49. Miscellaneous Antiques |
| 25. Lamps | |

**DIVISION O
CAKE DECORATING**

Coordinator - Pending

Adult Points apply to Culinary Arts Premiere Exhibitor

Section A - Adults, Beginner (3 years or less)

**Section B - Adults, Non-Professional Intermediate or
Advanced (4 or more years)**

Section C - Professionals/Teachers

A professional is defined as anyone who teaches Cake
Decorating or who designs and sells cakes for others.
Professionals may include a business size card to be displayed
with the cake.

Section D - Youth, ages 17 or Younger

Cakes may be real cakes or non-edible “dummy” cakes.
All cakes, whether submitted as a real cake or “dummy” cake
will be judged on skill of decorating. Cakes will not be tasted.

Real cakes will not be displayed during the Fair. Photos of
real cakes will be taken for display. Any non-edible cakes can
remain on display throughout the Fair.

Cakes should be submitted on Saturday, September 10
between 9:00 and 10:30 a.m. to Building C on the Fairgrounds.
Judging will begin at 10:45 a.m. and winners will be announced
by 12:00 noon. Photos will be taken of all cake entries for
display during the Fair and cakes will be released at noon.

1. Birthday Cake, Layered
2. Birthday Cake, Sheet
3. Groom’s Cake, any style
4. Wedding Cake, tiers may not total more
than 24” in height
5. Novelty Cake
6. Miscellaneous Layered Cake
7. Miscellaneous Sheet Cake
8. Cupcakes, 3-6 on display
9. Other Miscellaneous Specialty Cake

**DIVISION P
ADULT ART**

Mrs. Mary Copeland, Lindale
Ms. Tammi Copeland, Lindale

Mrs. Helen Jobe, Lindale
Mrs. Sherry Smith, Lindale

All entries must be the work of the exhibitor. Copies of non-original photographs or of other artists' paintings will be in the "Copies Class" only. Work done from photographs taken by the artist, friends, or family may be entered as original work. All paintings and drawings must have been completed within the last two years. Only 4 paintings per artist will be accepted.

Entries must be framed and hung by wires - no saw tooth Hangers. **Please leave 6 inch slack in wire on back of entry** to allow for easier hanging. Wood frames are preferred.

Section A - Adults, Beginner or Novice (3 years or less)

Section B - Adults, Intermediate (4 to 8 years)

Section C - Adults, Advanced (more than 8 years)

Section D - Teachers/Professionals

Oil Paintings

1. Landscape/Seascape
2. Structure/Architecture
3. Illustration
4. Portraits
5. Animals & Wildlife
6. Still Life
7. Floral
8. Abstract

Water Color

9. Landscape/Seascape
10. Structure/Architecture
11. Illustration
12. Portraits
13. Animals & Wildlife
14. Still Life
15. Floral
16. Abstract

Pastel

17. Landscape/Seascape
18. Structure/Architecture
19. Illustration
20. Portraits
21. Animals & Wildlife
22. Still Life
23. Floral
24. Abstract

Acrylic

25. Landscape/Seascape
26. Structure/Architecture
27. Illustration
28. Portraits
29. Animals & Wildlife
30. Still Life
31. Floral
32. Abstract

Ink

33. Landscape/Seascape
34. Structure/Architecture
35. Illustration
36. Portraits
37. Animals & Wildlife
38. Still Life
39. Floral
40. Abstract

Pencil/Charcoal/Colored

Pencil

41. Landscape/Seascape
42. Structure/Architecture
43. Illustration
44. Portraits
45. Animals & Wildlife
46. Still Life
47. Floral
48. Abstract

Mixed Media

49. Landscape/Seascape
50. Structure/Architecture
51. Illustration
52. Portraits
53. Animals & Wildlife
54. Still Life
55. Floral
56. Abstract

Specialty

57. Graphic/Technology
58. Scratch Art
59. Rolled Art
60. Collage
61. Calligraphy
62. Copies of Original Works

DIVISION Q
CROCHET, WEAVING, & TATTING

Mrs. Cheryl Davis, Tyler
Mrs. Connie Troxell, Whitehouse

Section A - Adults, Beginner or Novice (3 years or less)

Section B - Adults, Intermediate or Advanced (4 or more years)

Adult Points apply to Needle Arts Premier Exhibitor honors.

Items for babies and toddlers will only be accepted in
Division U - Infants and Toddlers.

Adults are limited to the following classes.

- | | | |
|---|-----------------------------------|--|
| General Crochet | | |
| 1. Bag or Purse | 21. Toy | |
| 2. Bedspread, fine thread | 22. Filet Crochet | |
| 3. Bedspread, heavy/coarse thread | 23. Miscellaneous Crochet | |
| Afghans | | |
| 4. Crochet Collars | 24. Afghan Stitch | |
| 5. Crochet Decorations (centerpieces, etc.) | 25. Broomstick Afghan (lace) | |
| 6. Crochet Pillow | 26. Double Crochet | |
| 7. Crochet Trim on Pillow-cases | 27. Granny Square | |
| 8. Doily Set, 2 or more pieces | 28. Indian Design | |
| 9. Doily, less than 14" | 29. Mixed Pattern | |
| 10. Doily, 14" and over | 30. Popcorn Design | |
| 11. Dolls | 31. Ripple Afghan | |
| 12. Garment for Adult | 32. Topped Afghan | |
| 13. Garment for Child | 33. Miscellaneous Afghan | |
| 14. Hot Mat or Pot Holder | Tatting | |
| 15. Item from Coarse Thread | 34. Doilies | |
| 16. Item from Fine Thread | 35. Edging | |
| 17. Lap Throw | 36. Pillowcases | |
| 18. Luncheon Set, 4 or more pieces | 37. Miscellaneous Tatting | |
| 19. Runner | Swedish Weaving | |
| 20. Tablecloth, any shape, over 54" | 38. Blanket | |
| | 39. Throws | |
| | 40. Miscellaneous Swedish Weaving | |

Section C - Youth, Ages 13 and Younger

Section D - Youth, Ages 14 to 17

Youth are limited to the following classes.

- | | | | |
|---|--|-----------------------------------|--|
| Crochet | | Swedish Weaving | |
| 1. Afghan, any Design | | 10. Miscellaneous Swedish Weaving | |
| 2. Bag or Purse | | Tatting | |
| 3. Crochet Decorations (centerpieces, etc.) | | 11. Miscellaneous Tatting | |
| 4. Crochet Pillow | | | |
| 5. Doily, less than 14" | | | |
| 6. Doily, 14" and larger | | | |
| 7. Doll or Other Toy | | | |
| 8. Garment | | | |
| 9. Hot Pad or Pot Holder | | | |

**DIVISION R
DOLLS**

Coordinators - Pending

Adult Points apply to Needle Arts Premier Exhibitor honors.

Section A - Beginner or Novice (3 years or less)

Section B - Intermediate (4 to 8 years)

Section C - Advance (more than 8 years)

Section D - Teachers/Professionals

Clothing on Dolls will be judged separately from the doll and should be registered in one of the following costume classes.

Dolls are hand-painted porcelain dolls.

Adult Points apply to Fine Arts Premier Exhibitor honors.

Dolls

1. Baby Doll
2. Child Doll
3. Fashion Doll
4. Miniature Doll
5. Adult Doll
6. Celebrity, Fictional, or Historical Character Doll
7. Ethnic Doll
8. Fantasy or Unique, including Clowns

Accessories

17. Accessory made of Wood
18. Accessory made of Cloth
19. Doll Jewelry
20. Doll Quilts
21. Doll Hats
22. Parasols
23. Doll Shoes
24. Wigs made by Exhibitor
25. Miscellaneous Accessory

Doll Costume

9. Baby Clothing
10. Child's Clothing
11. Adult Fashion Clothing
12. Miniature Costume
13. Bridal Apparel
14. Celebrity, Fictional, or Historical Character Costume
15. Ethnic Costume
16. Fantasy or Unique Clothing

Specialty

26. Doll Pairs
27. Antique Doll Reproduction
28. Complete Restoration - replacing parts, wigs, cleaning & making or refurbishing old clothes
29. Articles decorated with Doll Heads, Doll Faces, or Small Dolls
30. Miniature Settings

**DIVISION S
KNITTING**

Coordinator - Pending

Section A - Adults, Beginner or Novice (3 years or less)

**Section B - Adults, Intermediate or Advanced
(4 or more years)**

Adult Points apply to Needle Arts Premier Exhibitor honors.

Items for babies and toddlers are only accepted in Division U - Infants and Toddlers.

Adults are limited to the following classes.

Clothing

1. Man's or Lady's Pullover Sweater
2. Child's Pullover Sweater
3. Man's or Lady's Vest
4. Man's or Lady's Cardigan
5. Child's Cardigan
6. Man's or Lady's Cable Sweater

Home Accents

15. Afghan
16. Knitted Home Accessory

Miscellaneous

17. Miscellaneous Knitted Item

Accessories

7. House Shoes
8. Socks
9. Gloves or Mittens
10. Hats
11. Scarves
12. Shawls
13. Purses or Bags
14. Belts

Section C - Youth, Ages 13 and Younger

Section D - Youth, Ages 14 to 17

Youth are limited to the following classes.

1. Sweater or Vest
2. House Shoes, Socks, Gloves or Mittens
3. Hats
4. Scarves or Shawls
5. Purses or Bags
6. Belts
7. Afghan
8. Miscellaneous Knitted Item

**DIVISION U
INFANTS & TODDLERS**

Mrs. Wendy Thornton, Flint
Mrs. Gail Huggins, Tyler

Section A - Adults, Beginner or Novice (3 years or less)

**Section B - Adults, Intermediate or Advanced
(4 or more years)**

Adult Points apply to Needle Arts Premier Exhibitor honors

Baby Afghans

1. Knitted
2. Crochet

Quilts

3. Hand Quilted
4. Machine Quilted
5. Embroidered by Hand
6. Embroidered by Machine
7. Appliqué
8. Stencil
9. Tie-Tacked
10. Cross Stitch
11. Miscellaneous Quilts

Crib & Bed Articles

12. Crib Set, 2 or more pieces
13. Baby Pillowcase
14. Baby Blanket, Fabric
15. Baby Blanket, Other
16. Youth Bed Accessory
17. Miscellaneous Crib & Bed Articles

Clothing

18. Baby Sweater, knitted or crocheted
19. Sweater Set, 2 or more pieces
20. Booties
21. Coat
22. Coat Set
23. Dress, crocheted or knitted
24. Dress, Fabric
25. Dress, Smocked
26. Boy Suit, 2 or more pieces
27. Boy Outfit, Smocked
28. Shirt or Blouse
29. Rompers
30. Christening Set, 2 or more pieces
31. Christening Dress
32. Miscellaneous Clothing Item

Accessories

33. Hair Bows and Head Bands
34. Caps
35. Decorated Clothing
36. Toys, handmade from fabric, no kits
37. Decorative Wall Hanging
38. Miscellaneous Accessory

**DIVISION V
YOUTH ART**

Coordinators - Pending

Section A - Youth, Ages 10 to 13

Section B - Youth, Ages 14 to 17

Due to limited space, only 3 paintings per artist will be accepted. Entries **MUST BE FRAMED AND EQUIPPED WITH SCREWS AND WIRES for hanging. Please leave 6 inch slack in wire on back of entry** for easier hanging. Saw tooth hangers are unacceptable.

Oil Paintings

1. Landscape/Seascape
2. Structure/Architecture
3. Illustration
4. Portraits
5. Animals & Wildlife
6. Still Life
7. Floral
8. Abstract

Water Color

9. Landscape/Seascape
10. Structure/Architecture
11. Illustration
12. Portraits
13. Animals & Wildlife
14. Still Life
15. Floral
16. Abstract

Pastel

17. Landscape/Seascape
18. Structure/Architecture
19. Illustration
20. Portraits
21. Animals & Wildlife
22. Still Life
23. Floral
24. Abstract

Acrylic

25. Landscape/Seascape
26. Structure/Architecture
27. Illustration
28. Portraits
29. Animals & Wildlife
30. Still Life
31. Floral
32. Abstract

Ink

33. Landscape/Seascape
34. Structure/Architecture
35. Illustration
36. Portraits

37. Animals & Wildlife
38. Still Life
39. Floral
40. Abstract

Pencil/Charcoal/Colored Pencil

41. Landscape/Seascape
42. Structure/Architecture
43. Illustration
44. Portraits
45. Animals & Wildlife
46. Still Life
47. Floral
48. Abstract

Crayon

49. Landscape/Seascape
50. Structure/Architecture
51. Illustration
52. Portraits
53. Animals & Wildlife
54. Still Life
55. Floral
56. Abstract

Mixed Media

57. Landscape/Seascape
58. Structure/Architecture
59. Illustration
60. Portraits
61. Animals & Wildlife
62. Still Life
63. Floral
64. Abstract

Specialty

65. Graphic/Technology
66. Scratch Art
67. Rolled Art
68. Collage
69. Calligraphy
70. Non-original Design (Paint-by-number, Coloring Pages, etc.)

**DIVISION W
TOLE & DECORATIVE PAINTING**

Ms. Gloriann Spiller, Carthage
Ms. Patsy Bass, Tyler
Ms. Katie Best, Tyler
Ms. Jan Cox, Carthage
Ms. Dee Diederling, New London
Ms. Dixie McCormick, Tyler
Ms. Virginia Spurlock, Joaquin

Section A - Adults, Beginner or Novice (3 years or less)

Section B - Adults, Intermediate (4 to 8 years)

Section C - Adults, Intermediate (More than 8 years)

Section D - Teachers/Professionals

(has taught within the past 2 years)

Adult Points apply to Fine Arts Premier Exhibitor honors

(All Art on canvas goes to Division P - Adult Art.)

**Oils on Wood or Other Hard
Surface**

1. Floral
2. Fruits or Vegetables
3. Still Life - Realistic
4. Still Life - Primitive
5. People
6. Animals
7. Birds
8. Fish
9. Halloween
10. Santa Claus
11. Angels/Religious
12. Christmas
13. Christmas Ornament
14. Easter
15. Other Holiday
16. Patriotic theme
17. Stroke work
18. Rosemaling
19. American folk painting
20. European folk painting
21. Russian folk painting
22. Folk painting - General
23. Furniture - Small
24. Furniture - Large
25. Toys
26. Original design
27. Miscellaneous Oil

**Acrylics on Wood or Other
Hard Surfaces**

28. Floral
29. Fruits or Vegetables
30. Still Life - Realistic
31. Still Life - Primitive
32. People
33. Animals

34. Birds
35. Fish
36. Halloween
37. Santa Claus
38. Angels/Religious
39. Christmas
40. Christmas Ornament
41. Easter
42. Other Holiday
43. Patriotic theme
44. Stroke work
45. Rosemaling
46. American folk painting
47. European folk painting
48. Russian folk painting
49. Folk painting - General
50. Furniture - Small
51. Furniture - Large
52. Toys
53. Original design
54. Miscellaneous Acrylic

Water Color

55. Landscape or Seascape
56. Still Life - Real Life
57. Still Life - Primitive
58. Birds
59. Animals
60. People
61. Fruits or Vegetables
62. Original Design
63. Miscellaneous Water Color

Other

64. Porcelain, other than Dolls
65. Fabric Painting
66. Miscellaneous Other

DIVISION X CLOTHING

Mrs. Patsy Patterson, Lindale
Mrs. Sandra Alvey, Lindale
Mrs. Starlie Rinlee, Lindale

Due to limited space, only 6 classes per exhibitor. The entire item must be hand-made. Soiled items will not be accepted.

Section A - Adults, Beginner (less than 3 years)

Section B - Adults, Intermediate or Advanced (4 or more years)

Adult points apply to Needle Arts Premier Exhibitor.

Adults are limited to the following classes.

Clothing for Children and Pre-Teens

- | | |
|-----------------------------------|---------------------------------|
| 1. Blouse or Shirt | 21. Man's Shirt |
| 2. Casual or Play Outfit | 22. Skirt |
| 3. Coat or Jacket | 23. Suit, Lined |
| 4. Dressy Dress | 24. Suit, Unlined |
| 5. Jumpers | 25. Miscellaneous Adult Garment |
| 6. Pants or Trousers | |
| 7. School Dress | |
| 8. Skirt | |
| 9. Two-Piece Sets | |
| 10. Miscellaneous Child's Garment | |

Teen and Adult Clothing

- | | |
|-------------------------------------|---------------------------------|
| 11. Blouse | 26. Costumes |
| 12. Coat | 27. Ethnic Garment |
| 13. Combo Dress and Jacket | 28. Formal Dress, short or long |
| 14. Combo Pants and Blouse or Shirt | 29. Heirloom Dress |
| 15. Combo Skirt and Blouse | 30. Man's or Boy's Formal Wear |
| 16. Combo Skirt and Vest | 31. Wedding Dress |
| 17. Dress, Casual | 32. Wedding Veil |
| 18. Dress, Dressy | |
| 19. Jacket | |
| 20. Jumper | |

Specialty Clothing

Accessories

- | |
|---------------------------------------|
| 33. Bags, sewn fabric |
| 34. Belts, sewn fabric |
| 35. Collars |
| 36. Vest |
| 37. Other Accessory Item, sewn fabric |

Section C - Youth, ages 13 and Younger

Section D - Youth, ages 14 to 17

Youth are limited to the following classes.

Youth Clothing

- | | |
|--------------------|--------------------------|
| 1. Blouse or Shirt | 9. Vest |
| 2. Casual Outfit | 10. Other Accessory Item |
| 3. Dressy Dress | |
| 4. Formal Wear | |
| 5. Pants or Shorts | |
| 6. Skirt | |

Youth Accessories

- | |
|----------------------|
| 7. Bag, sewn fabric |
| 8. Belt, sewn fabric |

Youth Specialty Items

- | |
|---------------------|
| 11. Costume |
| 12. Ethnic Clothing |
| 13. Heirloom Dress |

Miscellaneous

- | |
|---------------------------------------|
| 14. Miscellaneous Youth Clothing Item |
|---------------------------------------|

VOLUNTEER OPPORTUNITIES

To volunteer for the Creative Arts or other contests and events:

Fair Office: 903-597-2501

E-Mail: dnewman@etstatefair.com

OTHER EAST TEXAS STATE FAIR COMPETITIVE EVENTS

Ag Mechanics Show

For 4-H and FFA Groups

On display during the Fair

Livestock Show

September 23 through October 1

Photography Show

Entries Received at Batten PhotoGem Labs

3929 S. Broadway in Tyler

August 27 through September 7

Monday-Friday, 8:30 a.m. to 5:30 p.m.

Saturday, 9:00 a.m. to 3:00 p.m.

SPECIAL ACTIVITIES

AgriWorld Educational Display and Tours

Display open throughout the Fair

Tours scheduled September 27-30

See website for tour registration.

Senior Day

Opening Day - Thursday, September 22

Activities and entertainment throughout the day

All ages 55 or better admitted FREE

Go to www.etstatefair.com for event rules and other East Texas State Fair information.

Entertainment and Attractions

Eudora Farms Petting Zoo

Sandscapes

Swiftly Swine

See Fair website for schedule.

CREATIVE ARTS COMMITTEE

Ms. Patrice Dunagin, Smith County AgriLife Extension
Ms. Penny Hunter, Smith County AgriLife Extension
Mrs. Harriett Lane, Tyler
Mrs. Patty Morgan, Tyler
Ms. Carol Schuler, Tyler
Mrs. Jerri Simonton, Tyler
Ms. Kathy Tidwell, Tyler
Ms. Vickie Wood, Tyler

REGISTRATION AND CHECK-IN SUPPORT

Mrs. Ann Cantrell, Tyler
Ms. Sarah Hindman, Smith County AgriLife Extension

ETSF STAFF

Mrs. Deborah Newman, Director of Competitive Events
Ms. Cookie Young, Administrative Assistant
Mrs. Denise Weaver



THANK YOU!

To the numerous

VOLUNTEER WORKERS

who willingly give of their time to make
the Creative Arts Contest possible.

Your assistance not only
enhances the quality of this
department, it enhances the quality of

the East Texas State Fair!



**EAST TEXAS STATE FAIR
2112 West Front St.
Tyler, Texas 75702**

**Non Profit
Organization
U.S. Postage
PAID
Tyler, Texas
75702
Permit No. 221**